

TECHNICAL DATASHEET
**WRAS APPROVED ANGLE
VALVE**



HOME CREATOR



Item No.: HC-1175Y, HC-1177Y

1 CERTIFICATION INFORMATION

Declaration of conformity: WRAS approved angle valve, Confirmation of the approval can be obtained from the WRAS Approvals Directory (www.wras.co.uk/directory)

Approval Number: 240704034

2 PRODUCT BASICS

Product Name: WRAS APPROVED ANGLE VALVE

Purpose: It is used as a shut-off valve in pipeline systems (water supply, household drinking, heating), transporting any media that are not aggressive to the materials of the product.

Manufacturer (supplier): HOME CREATOR TECHNOLOGY CO., LTD (Qinggang, Yuhuan, Taizhou, Zhejiang province, China).

3 MAIN TECHNICAL DATA AND CHARACTERISTICS

3.1 SPECIFICATIONS

Table 1

Angle valves for connecting plumbing fixtures			
Item Code	HC-1175Y, HC-1177Y		
Connection thread, Inch	3/8"x1/2"	3/4"x1/2"	1/2"x1/2"
Nominal pressure PN, MPa	1.0		
Test pressure Ppr, MPa	1.5		
Working temperature range, °C	0 to +90		
Throughput coefficient, m³/h	2.23		
Maximum torque at installation, Nm	30		
Seal tightness	Class A		
Connection thread (ISO 228)	Parallel		
Average full service life	15		



3.2 MATERIAL OF MANUFACTURE AND CONSTRUCTION OF ANGLE VALVE

Table 2

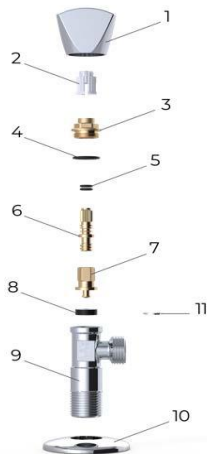

Name	Material
Handle Wheel (1)	ZINC
Plastic Fasteners (2)	PA
Cap (3)	Brass CW617N
O-ring (4)	NBR
O-ring (5)	NBR
Lead Screw (6)	Brass CW617N
Water Stop Plate (7)	Brass CW617N
Rubber Mat (8)	EPDM
Valve Body (9)	Brass CW617N
Decorative Cover (10)	201
Circlip (11)	304

1. HOME CREATOR brass products are made by hot stamping of brass grade CW617N as per the European standard EN12165.
2. O-Ring are made of N7118F NBR according to European standards.
3. The Rubber Mats are made of EP8018F EPDM according to European standards.

3.3 MAXIMUM PRESSURE CONDITIONS

Table 3

Item	Max Pressure (bar)	Min/Max Temperature (°C)	Test Pressure		Max Pressure (psi)	Min/Max Temperature (°F)	Test Pressure	
			Shell (bar)	Seat (bar)			Shell (psi)	Seat (psi)
HC-1177Y	10.0	4 °C +120 °C	15.0	11.0	145.0	39.2°F +248 °F	217.5	159.5
HC-1175Y	10.0	4 °C +120 °C	15.0	11.0	145.0	39.2°F +248 °F	217.5	159.5

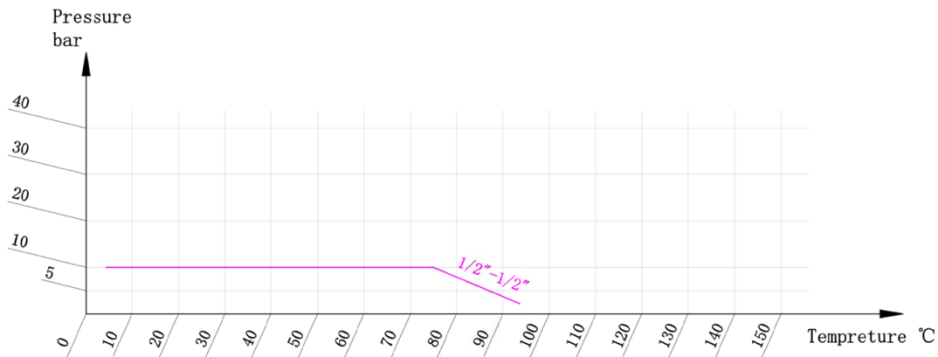

3.4 ANGLE VALVE

Male-Male thread (MxM)



3.5 CROSS SECTION

Male-Male thread (MxM)

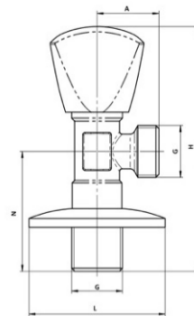

Table 4

Item	DN	Size	Weight, g	Overall dimensions, mm				
				G	A	H	N	L
HC-1175Y	10	3/8"x1/2"	171	3/8"	24.5	95.9	45	55
HC-1175Y	15	3/4"x1/2"	180	3/4"	25	95.9	45	55
HC-1175Y	20	1/2"	171	1/2"	25	95.9	45	55



3.6 ANGLE VALVE

Male-Male thread (MxM)



3.7 CROSS SECTION

Male-Male thread (MxM)

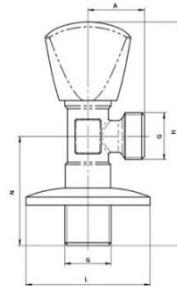

Table 5

Item	DN	Size	Weight, g	Overall dimensions, mm				
				G	A	H	N	L
HC-1177Y	10	3/8"x1/2"	213	3/8"	26	81	45	55
HC-1177Y	15	3/4"x1/2"	224	3/4"	26	81	45	55
HC-1177Y	20	1/2"	217	1/2"	26	81	45	55



4 INSTALLATION AND OPERATION

- 4.1 Installation of a angle valve should be carried out by a specialist or a specialized organization in accordance with the Installation Requirement Notes (IRNs) "WRAS water regulation approval schedule".
- 4.2 Sealing of threaded connections should be carried out using standard sealing materials.
- 4.3 The angle valve should not experience loads from the pipeline (when bending, compressing, stretching, torsion, braiding, vibration, uneven tightening of the fasteners, etc.)
- 4.4 Upon completion of the installation work, it is necessary to carry out individual tests of the equipment with the preparation of the act.
- 4.5 The angle valves shall be operated in accordance with the characteristics specified in paragraph 3. of this technical passport.
- 4.6 The angle valve has only two operating positions: fully open or fully closed. It is not allowed to use HOME CREATOR angle valves as control valves, this can lead to a reduction in service life.
- 4.7 In the case of using the valve in pipeline systems with a high content of mechanical impurities, it is recommended to additionally mount a U-shaped filter for cleaning HOME CREATOR (Art. HC-10502).

5 DESCRIPTION AND WORK

The angle valve blocks the flow of the transported medium with a spherical gate shape. The shutter rotates 90 degrees by transmitting torque from the crane handle through the rod. The bolt has seals on the sides of the outlet pipes and rod.

6 MAINTENANCE

- 6.1 Articles must be operated within the values specified in para. 3, para. 4 of this technical passport.
- 6.2 To extend the service life of sealing elements, it is recommended to open / close the HOME CREATOR angle valve at least 1 time in 6 months.

7 STORAGE AND TRANSPORTATION CONDITIONS

Products are transported in the packaging of the manufacturer in accordance with the rules operating on the mode of transport used.



- 8.1 Average full service life of a angle valve: 15 years.
- 8.2 The manufacturer (supplier) guarantees the operability and compliance with the safety requirements of the product if the consumer complies with this technical passport HC- HC-1175Y, HC-1177Y.
- 8.3 Warranty period: 36 months from the date of sale to the end user / from the date of commissioning of the object. The warranty covers all defects caused by the manufacturer.
- 8.4 When making claims about the quality of the goods, the buyer provides the following documents:
 - 8.4.1 An application in any form, which indicates:
 - a) Name of the organization or F. And. About. buyer, actual address, contact phone number;
 - b) The name and address of the organization that carried out the installation of the product; c) a brief description of the malfunction of the product.
 - 8.4.2 A document confirming the purchase of the product (cash/sales receipt, waybill, receipt, etc.).
 - 8.4.3 Photos of the product confirming its malfunction, or the product itself.
 - 8.4.4 Act of hydraulic testing of the system in which the product was mounted.
 - 8.4.5 Completed warranty card.
- 8.5 The warranty does not cover defects arising from:
 - 8.5.1 Violations of the passport regimes of storage, transportation, installation and operation of the product.
 - 8.5.2 The presence of traces of extraneous interference in the design of the product.
 - 8.5.3 Effects of substances aggressive to the materials of the product.
 - 8.5.4 Effects on the product of excessive force.
 - 8.5.5 Impact on the product of fire, natural disasters and other force majeure circumstances.
- 8.6 The warranty also does not apply in cases where the manufacturer's markings are partially or completely changed, erased, removed or illegibly visible.
- 8.7 In case of unreasonableness of the claim, the costs of diagnostics and examination of the product are paid by the buyer.
- 8.8 Manufacturer HOME CREATOR TECHNOLOGY CO. LTD reserves the right to make changes to the design of the product that do not affect the declared technical characteristics.
- 8.9 Claims for the quality of the goods can be made during the warranty period at the address of the manufacturer HOME CREATOR TECHNOLOGY CO. LTD.



- 9.1 Angle valves packed by the manufacturer.
- 9.2 Packaging ensures the safety of products subject to compliance with clause 7.
- 9.3 The materials and substances used for packaging are safe for people and the environment.
- 9.4 The angle valve is in the open position.
- 9.5 The batch of angle valves is recognized as suitable for operation and is accepted with 100% control at $RPR = 1.5 * Py$.

Date of manufacture		QUALITY Mark	
----------------------------	--	---------------------	--



10 NOTE

This image shows a blank sheet of white paper with horizontal ruling lines. The lines are evenly spaced and run across the width of the page. There are no margins or other markings on the paper.

Name: ANGLE VALVE

Article: HC-1175Y, HC-1177Y

Quantity: _____

Name and Address of the trading organization: _____

Date of Sale: _____ Seller's full name / Seller's signature, Stamp / seal of the trading organization: _____

I agree with the terms of the warrant: _____

Product Return Mark: _____

Buyer's signature: _____

View your passport Online:



Date / Signature: _____

WARRANTY PERIOD: 36 MONTHS

Warranty is provided.
according to paragraph 8 of the technical passport HC-1175Y, HC-1177Y





HOME CREATOR

HOME CREATOR Middle East Fzco
Add: Building A1, Dubai Digital Park,
Dubai Silicon Oasis, Dubai, UAE